

Konfiguration af Growatt overvågningssystem

OBS! Det anbefales at vente med at udføre konfigurationen imens elektrikerer installerer inverteren.

Step 1

Download ShinePhone app fra App Store eller Google Play.



Step 2

Tryk på "Register".

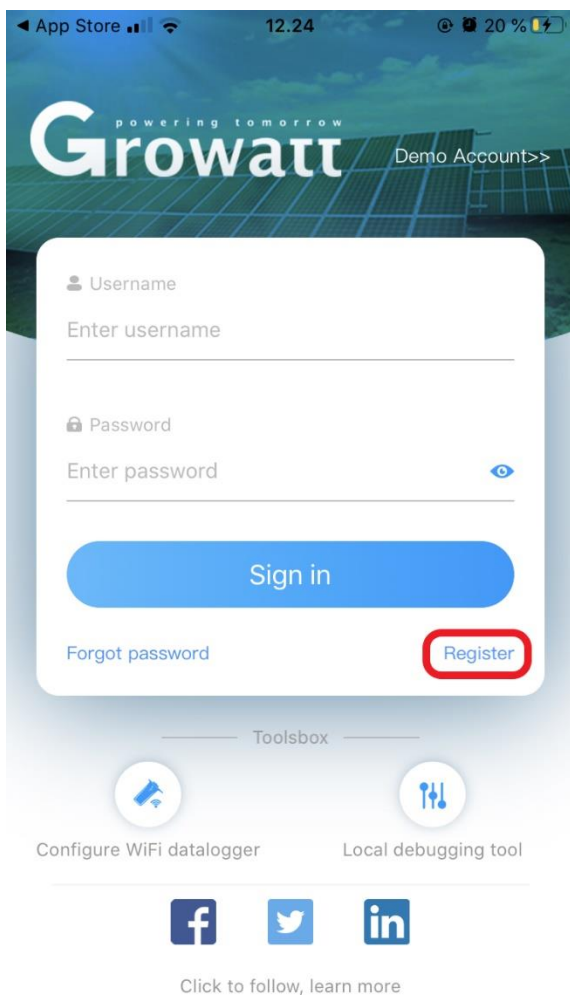

Step 3

Indtast dine selvvalgte oplysninger og benyt installer code: "ALRJ6". Markér "Agree the user agreement" og tryk "Register".

The screenshot shows a mobile registration form titled "Register". At the top, there are status icons for signal strength (3 bars), Wi-Fi, time (12.28), and battery (21%). The form has a "Back" button and a "Register" button. The fields are as follows:

- Country: Denmark
- Username: Brugernavn
- Password: (empty)
- Repeat password: (empty)
- Phone: Enter phone number
- Email: Mail@mail.dk
- Installer code: ALRJ6

Below the fields, there is a grey box with the following text:

You can find Installer code from installer OSS account
Register OSS account at <http://oss.growatt.com/login?lang=en>, or contact +496997461269 for help

At the bottom of the grey box, there is a checkbox labeled "Agree the user agreement" which is checked. Below this is a blue "Register" button.

Step 4

Indtast oplysninger i felterne, hvor "PV capacity" er antal paneler x paneleffekt:

Eksempel:

4 x 350Wp paneler på øst-vendt tagflade og 6 x 350Wp paneler på syd-vendt tagflade:

$$(4 \times 350W) + (6 \times 350W) = 3500 W$$

Vælg "Residential plant" som "Plant type".

📶 3 📶 12.30 📶 21% 🔋

Add Plant Skip

* Plant name Adresse

* Installation date 2020-04-23 📅

Plant address

📍 Get from the map Automatic Manual

* Denmark 📄 Copenhagen 📄

Vej husnummer

12.56553 📄 55.675941 📄

* Time zone +2 📄

* PV capacity(W) 3500

* Plant type

Residential plant Commercial Plant Ground-mounted plants

(Conversion standard based on 1kWh power generation)

Fund Revenue DKK 📄

Step 5

1. Scan kode på dit Growatt Wifi modul.

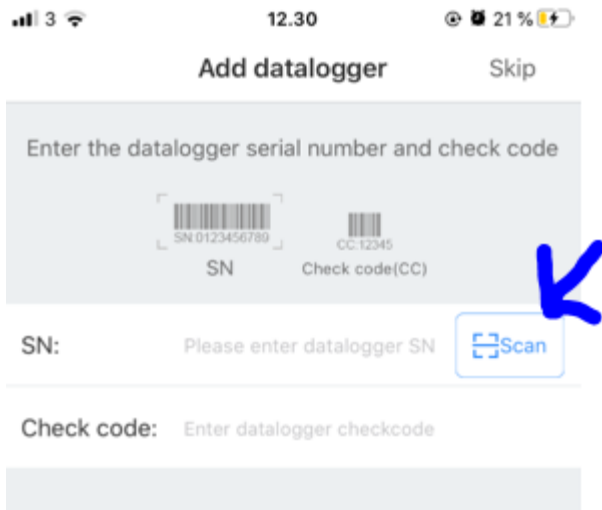

The screenshot shows the 'Add datalogger' screen in the Growatt app. At the top, there are status icons for signal strength (3 bars), Wi-Fi, time (12.30), and battery (21%). Below the title 'Add datalogger' is a 'Skip' button. The main instruction reads 'Enter the datalogger serial number and check code'. There are two barcode placeholders: one for 'SN' (Serial Number) with the example 'SN 0123456789' and one for 'Check code(CC)' with the example 'CC: 12345'. Below these is a 'Scan' button with a blue arrow pointing to it. The 'SN:' field contains the text 'Please enter datalogger SN' and the 'Check code:' field contains 'Enter datalogger checkcode'.

2. Scan **Serienummeret** eller **QR kode**

OBS!

Hvis du har et fladt Wifi modul (Shine WIFI S) skal du scanne serienummeret på bagsiden.

Hvis du har et rundt Wifi modul (Shine WIFI X) skal du scanne QR koden på forsiden



Shine WIFI S



Shine WIFI X



3. Vælg Method 1: 2.4 GHz

Efterfølgende popper **location service** op hvis du ikke har slået lokalitetstjenester til på din telefon. Dette skal blot slås til.



< Select router connection mode of dat...

Please determine the frequency band of the router. Please select mode 1 for 2.4G band. Select mode 2 for 2.4G+5G dual-band. The datalogger does not support single-band 5G router. (You can enter the router's built-in page to view the current band of the router)



Method1: 2.4GHz



Method2: 2.4GHz+5GHz

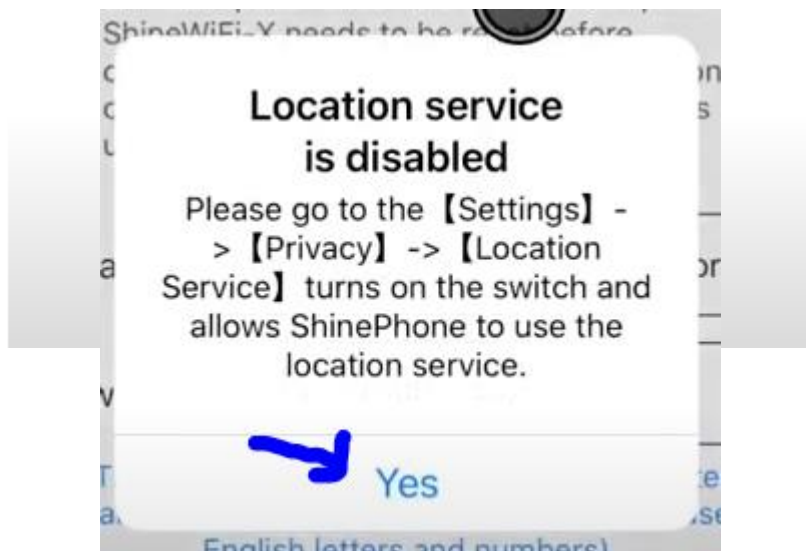

4. Vælg **Configuration** og efterfølgende **Yes** til at forbindelsen kan oprettes

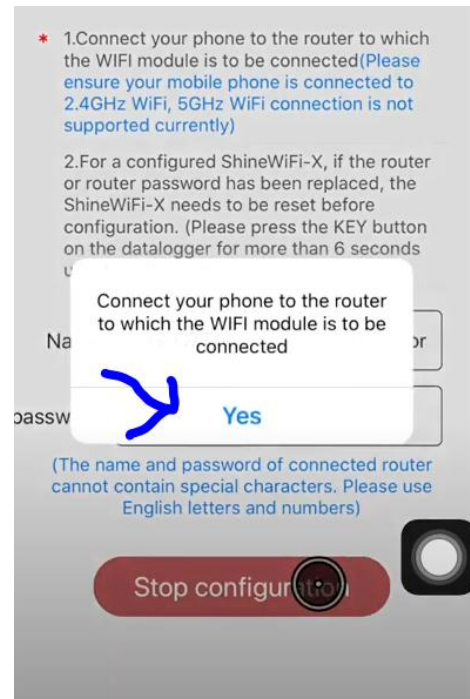
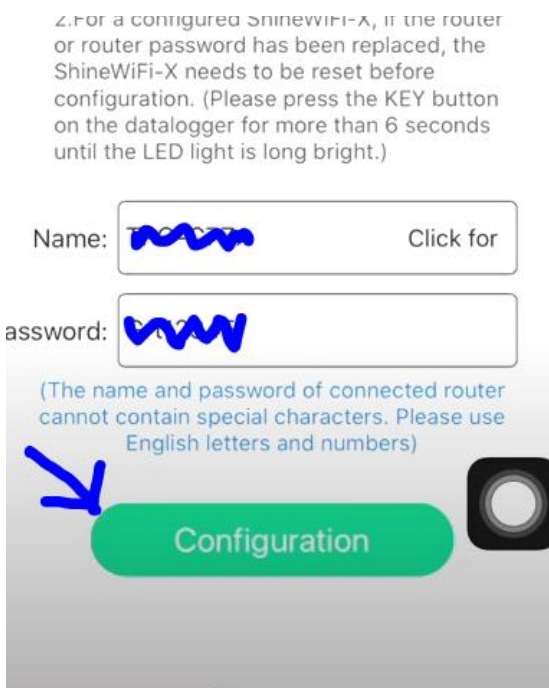

5. Dit anlæg er herefter oprettet.
Du kan nu følge produktionen via din App.

